

# 15' X 15'

Main Profile Size		
Purpose	Leg, Eaves Rail & Gable Pole	5' Eve Tube

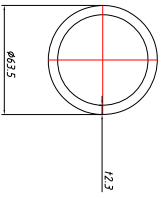
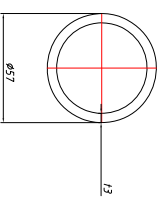

Temporary Use ONLY

Setup Date: \_\_\_/\_\_\_/\_\_\_

Take Down: \_\_\_/\_\_\_/\_\_\_

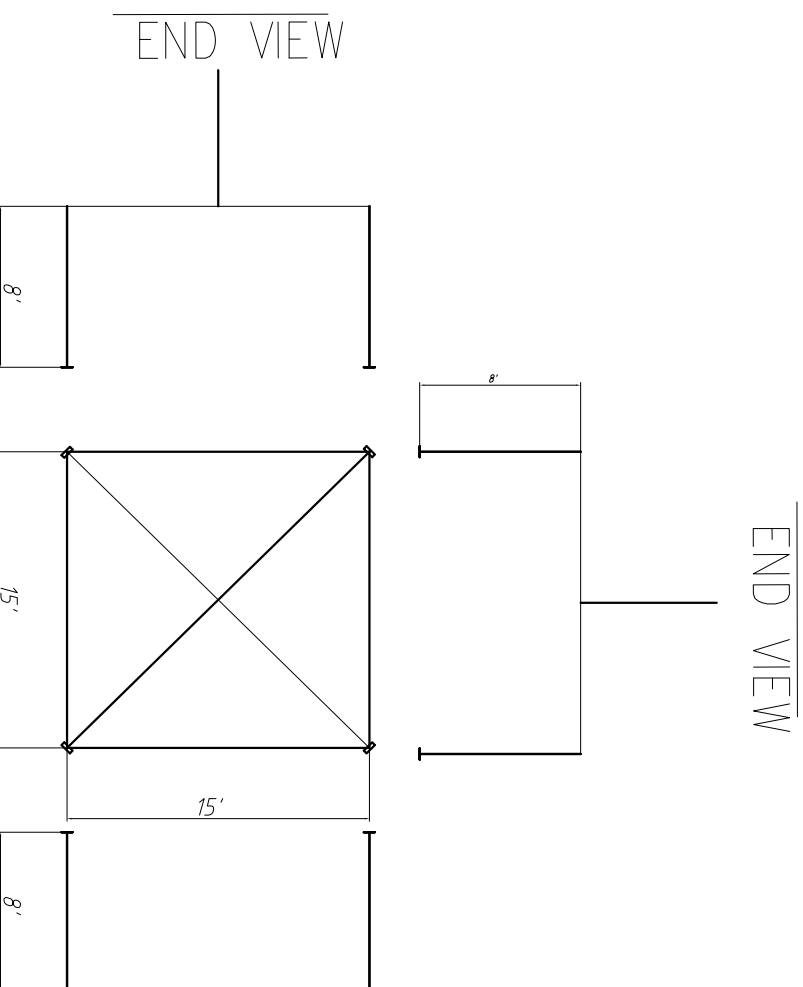
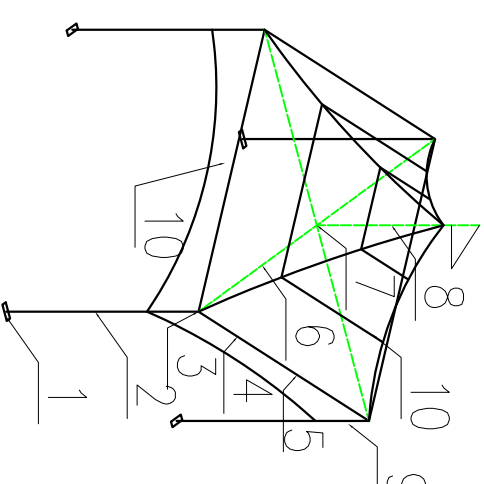

END VIEW

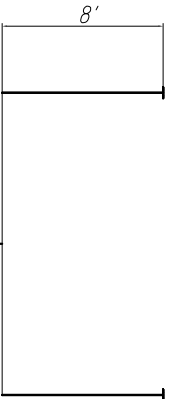

END VIEW

11	Wall 8'x15'		4pcs
10	Top 15'x15'		1pcs
9	Hex Screw	M8*70	6pcs
8	Center Pole 10'x10'	φ63.5x1320	1pcs
7	Pins		5pcs
6	15' x 15' Cross Cable	φ8x6185	2pairs
5	5' Eave Tube Alum	φ63.5x1740	4pcs
4	10' Eave Tube Alum	φ63.5x2820	4pcs
3	90deg Corner		4pcs
2	Corner Leg	φ63.5x2430	4pcs
1	Bose	180*60*170	4pcs

### Revision info

Rev.	Revised matter	Drawn	Approved	Date
1	ISSUED FOR CONSTRUCTION		RMB	08.06.13

Consultant Stamp



**Cosco TENT**

**SPECIAL Event SALES**

Drawn By	Manager	Checked	Approved
----------	---------	---------	----------

Dwg No. **SES- 1515**

Mat 1  
GNOI-TG  
JIS H4100-1982

Scale	Date
1:1	13-07-13

### Remarks

**ANCHOR REQUIREMENTS**  
@ 80 kph  
Uplift Forces: 8.4 kN  
Horizontal Forces: 1.8 kN  
Vertical Uplift: 860 kg  
Tent Weight: 139 kg  
Min Net Ballast: 721 kg

- Consultant Scope of Work is Limited to:
- 1) Scope of work is limited to the review of structure performance in wind gusts not exceeding the max wind speed as defined below.
  - 2) Scope of work does not include physical testing of the tent materials, review of site conditions, tent erection procedures or inspection of the erected structure.
  - 3) Scope of work shall not be construed as approval or guarantee that the erected tent structure will perform safely or otherwise for any particular use or site.
  - 4) The consultant will not be held liable for injury or property damage resulting from any and all use or application of the tent structure.
- Winds loads : NBC2010 & ASCE 7-10  
Exposure: B  
Category: 2  
Max q: 0.283 kPa  
Max V: 80 kph  
Snow Loads: None